

RSC REVISION WORKSHEETS

Year 9

CONVERTING ORTHOGRAPHIC DRAWING TO ISOMETRIC DRAWING

THE FRONT ELEVATION OF AN ORTHOGRAPHIC DRAWING SHOWS THE LENGTH & HEIGHT OF THE SHAPED BLOCK, THE END ELEVATION SHOWS THE WIDTH & HEIGHT AND THE PLAN SHOWS THE LENGTH & WIDTH.

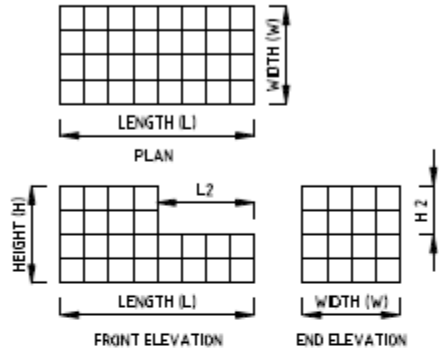

CONSTRUCTION OF THE ISOMETRIC BOX

FIRST THE HEIGHT LINE IS DRAWN VERTICALLY, THEN THE LENGTH AND THE WIDTH OF THE ISOMETRIC BOX ARE DRAWN.

THE OTHER 2 HEIGHT LINES ARE ADDED AS WELL.

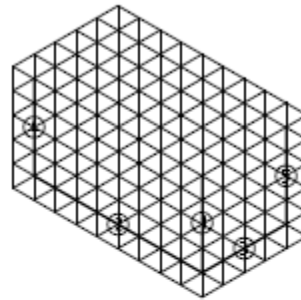

CONSTRUCTION OF THE ISOMETRIC BOX

THE OTHER LENGTH AND WIDTH LINES ARE THEN DRAWN TO COMPLETE THE ISOMETRIC BOX.

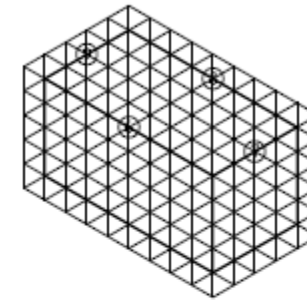

COMPLETING THE SHAPE

TO GET THE SHAPE OF THE OBJECT THE LENGTH 2 (L2) AND HEIGHT 2 (H2) ARE TAKEN FROM THE FRONT AND END ELEVATION AND DRAWN BY COUNTING THE NUMBER OF GRIDS.

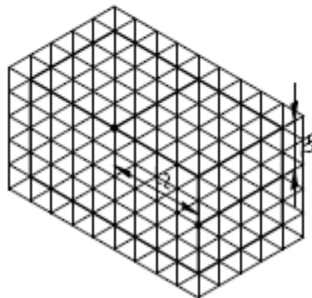

COMPLETING THE SHAPE

THE REMAINING LINES ARE DRAWN TO COMPLETE THE SHAPE.

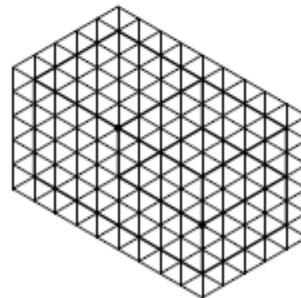

COMPLETING THE SHAPE

THE SHAPE IS COMPLETED BY DRAWING THE OUTLINES.

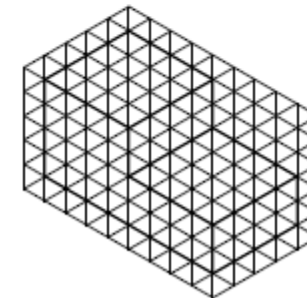

NAME: _____

YEAR: _____

ISOMETRIC DRAWING

DATE: _____

SHEET NO: 45

RSC REVISION WORKSHEETS

Year 9

GIVEN: A SHAPED BLOCK DRAWN IN 3rd ANGLE PROJECTION AND AN ISOMETRIC GRID

REQUIRED: DRAW THE ISOMETRIC VIEW OF THE SHAPED BLOCK ON THE ISOMETRIC GRID.
(USE THE GIVEN STARTING POINT)

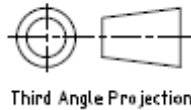
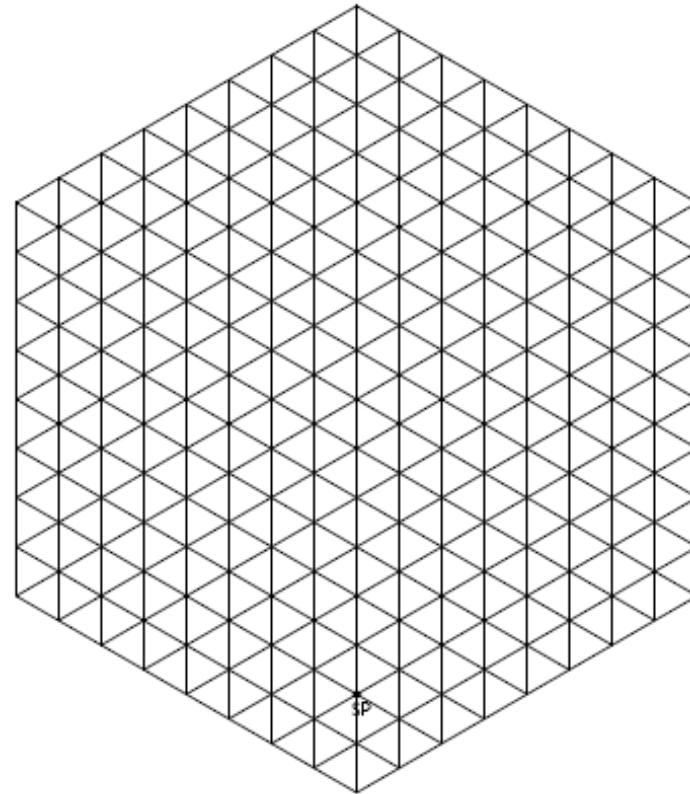
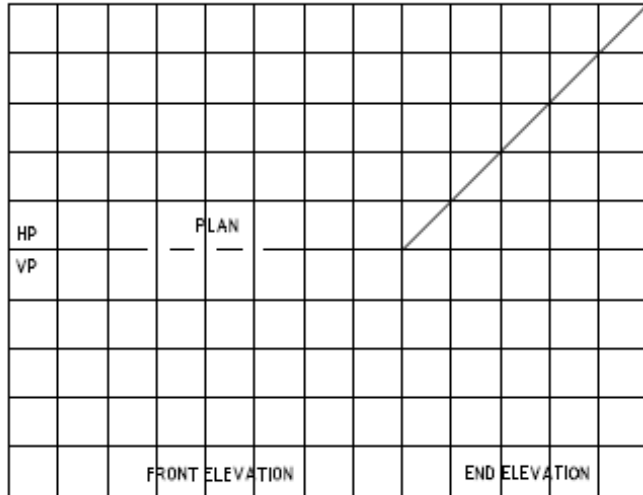

NAME: _____

YEAR: _____

DATE: _____

SHEET NO: 49

RSC REVISION WORKSHEETS

Year 9

GIVEN: A SHAPED BLOCK DRAWN IN 3rd ANGLE PROJECTION AND AN ISOMETRIC GRID

REQUIRED: DRAW THE ISOMETRIC VIEW OF THE SHAPED BLOCK ON THE ISOMETRIC GRID.
(USE THE GIVEN STARTING POINT)

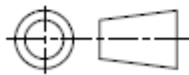
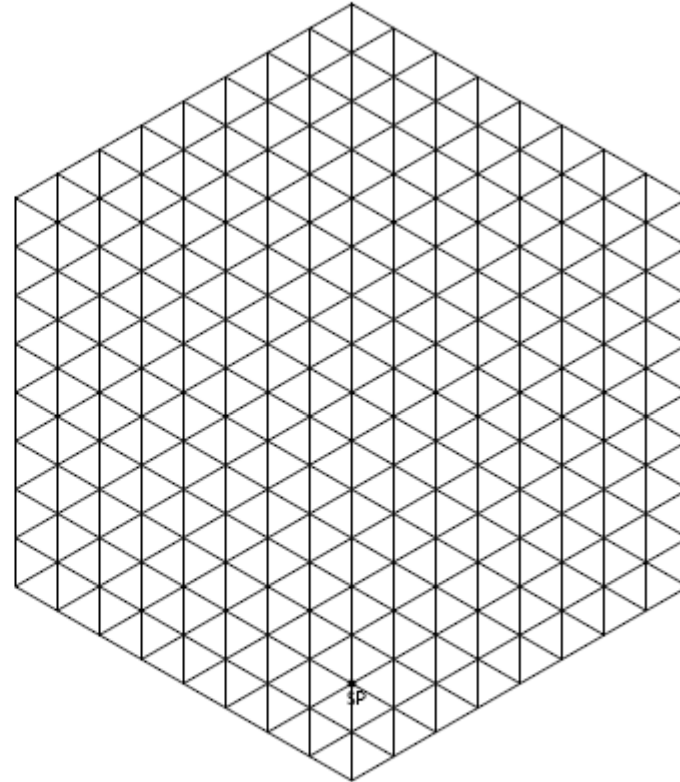
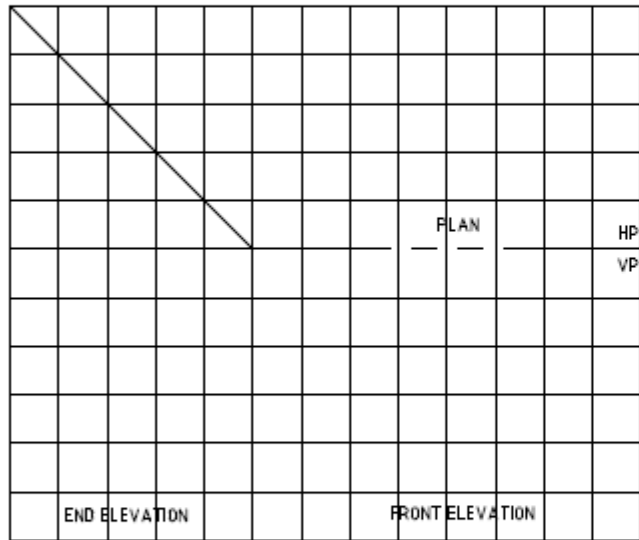

Third Angle Projection

NAME: _____

YEAR: _____

DATE: _____

SHEET NO: 48

RSC REVISION WORKSHEETS

Year 9

GIVEN: A SHAPED BLOCK DRAWN IN 3rd ANGLE PROJECTION, ISOMETRIC AXIS AND THE STARTING POINT 'O'.

REQUIRED: LABEL THE GIVEN ORTHOGRAPHIC VIEWS

DRAW THE ISOMETRIC VIEW OF THE SHAPED BLOCK USING THE GIVEN ISOMETRIC AXIS AND THE STARTING POINT 'O'.

NOTE: TAKE MEASUREMENTS DIRECTLY FROM THE ORTHOGRAPHIC VIEW

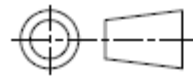
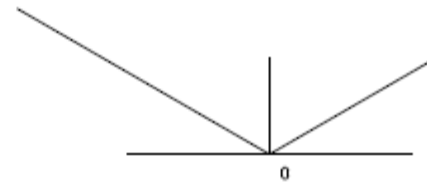
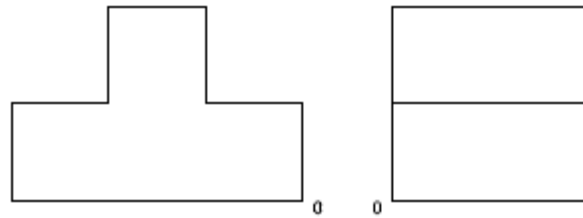
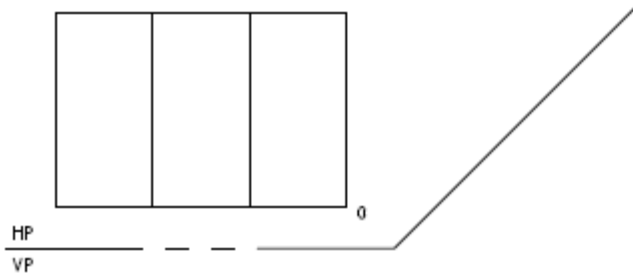

Third Angle Projection

NAME: _____

YEAR: _____

DATE: _____

SHEET NO: 50

RSC REVISION WORKSHEETS

Year 9

GIVEN: A SHAPED BLOCK DRAWN IN 3rd ANGLE PROJECTION, ISOMETRIC AXIS AND THE STARTING POINT 'O'.

REQUIRED: LABEL THE GIVEN ORTHOGRAPHIC VIEWS

DRAW THE ISOMETRIC VIEW OF THE SHAPED BLOCK USING THE GIVEN ISOMETRIC AXIS AND THE STARTING POINT 'O'.

NOTE: TAKE MEASUREMENTS DIRECTLY FROM THE ORTHOGRAPHIC VIEW

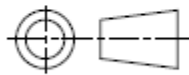
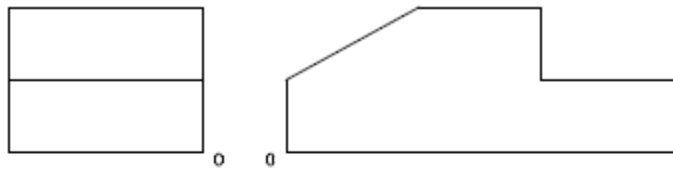
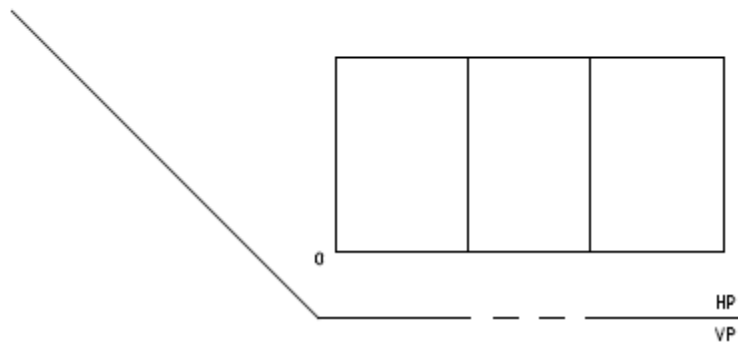

Third Angle Projection

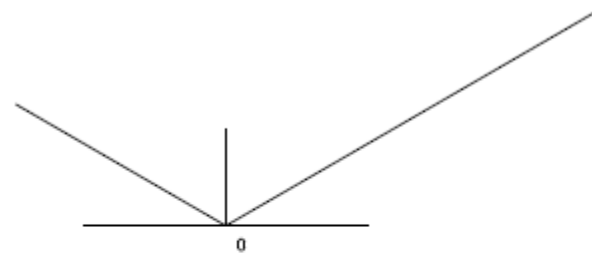

NAME: _____

YEAR: _____

DATE: _____

SHEET NO: 51

RSC REVISION WORKSHEETS

Year 9

GIVEN: A SHAPED BLOCK DRAWN IN 3rd ANGLE PROJECTION AND THE ISOMETRIC AXIS.

REQUIRED: LABEL THE GIVEN ORTHOGRAPHIC VIEWS

DRAW THE ISOMETRIC VIEW OF THE SHAPED BLOCK USING THE GIVEN ISOMETRIC AXIS.

NOTE: TAKE MEASUREMENTS DIRECTLY FROM THE ORTHOGRAPHIC VIEW

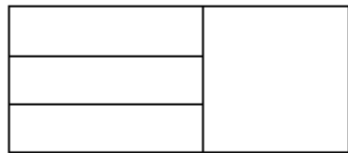

HP
VP

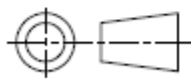
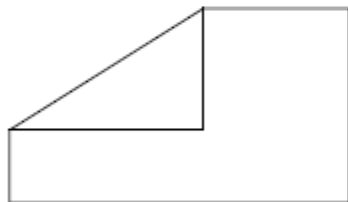

Third Angle Projection

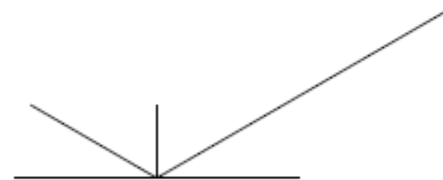

NAME: _____

YEAR: _____

DATE: _____

SHEET NO: 53