

RISHIKUL SANATAN COLLEGE
DEPARTMENT OF COMPUTER STUDIES
YEAR 12 – WORKSHEET 4
COMPUTERS IN SOCIETY

a) Study the image given below and discuss what the picture depicts?



b) Use the picture below to answer the questions that follow.

range of appropriate background reading er- can be very daunting. Writing for gether your knowledge and understanding vill gain an ability to use language y to communicate the ideas of others as le to understand what it means to cite ess as an academic author.

rucial academic skill: eferencing helps ;, ar], not least, avoid one of the most sm is a term used to describe a practice that and claiming it, directly or indirectly, as oduced by another person, 'published' in omain. It is not the ideas per se that are t is the manifestation of those ideas: in phic or other tangible form. It can also , and sold from internet sites, which are n original work (Neville, 2010).

se ideas from others all the time, then ibly taking ownership of them until we his way, referencing can become difficult, er, refers to an intentional decision not to g usually well- publicised obligations to do if it were your own is often considered a

Match Overview
✕

A → 33%

<		>
1	infolib.vnua.edu.vn <small>Internet Source</small>	15% >
2	web.msu.ac.zw <small>Internet Source</small>	12% >
3	quod.lib.umich.edu <small>Internet Source</small>	4% >
4	link.springer.com <small>Internet Source</small>	2% >

B

C

(i) Which ethical issue was addressed using the program above?

(ii) Identify the program used to carry out the task.

c) Use the pictures given below to answer the questions that follow.

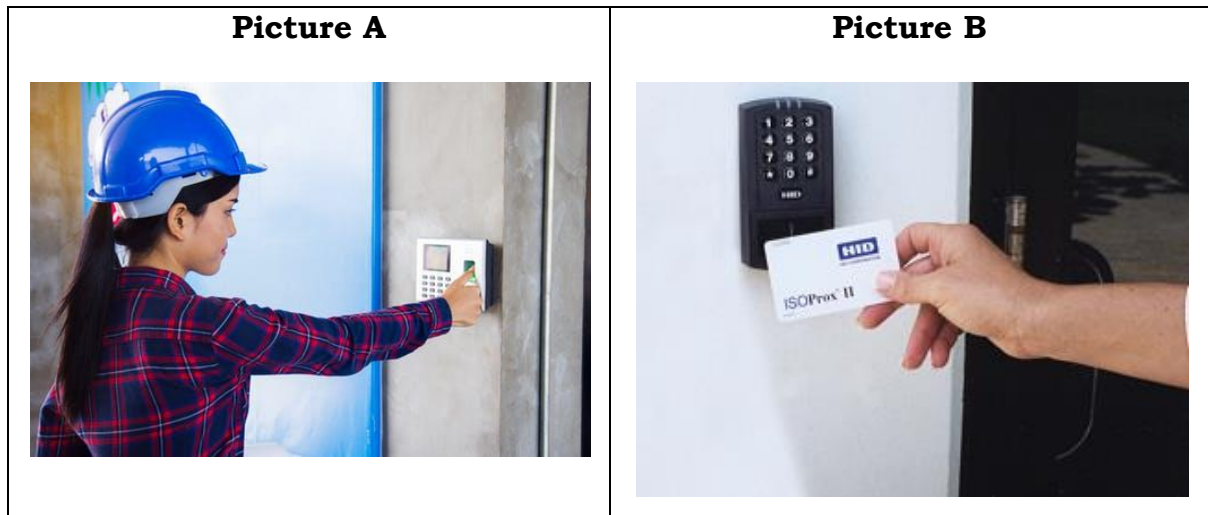

- (i) What security measure is common in Picture A and B?
- (ii) For the security measure mentioned in (i) above, Picture A is different from that of Picture B. Explain how this is so.
- (iii) Explain in your own words where the security measure in Picture A and Picture B is frequently used.

d) Differentiate between history file and cookies.

e) There are hazards to computer systems and data besides criminals. Discuss **two** of this hazard.

f) Explain what Internet scam is?